

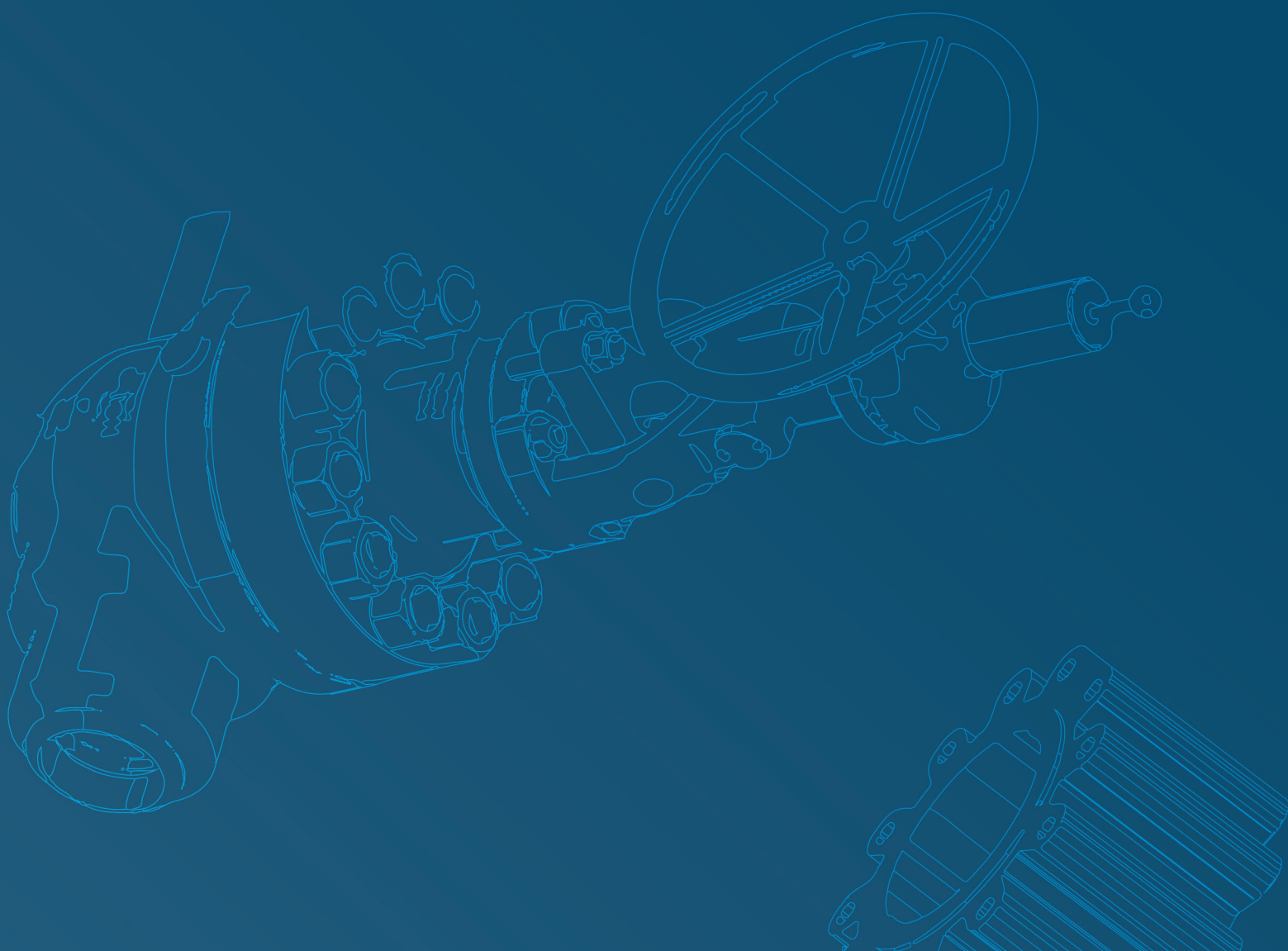

ORION
Valves

OUR PRODUCTION RANGE



Established in 1951

Company profile

ORION S.p.A. is a valve manufacturer based in Trieste, Italy. The company headquarters spans approximately 47.000 sq.m, of which 20.000 sq.m are covered.

With over 70 years of experience in Oil & Gas application for most critical services, **ORION** presents its product line of Steel Valves incorporating new and revised designs, specially engineered to meet specific demands and requirements of the petroleum and chemical industries.

Range of products

- Gate, Globe, Check, Rising Stem Ball, Ball, Axial On-Off, Butterfly TOV
- Acc. to API 6A (PSL 1, 2, 3,4) - API 6D, API 6D SS - API 623 - API 600 - API 609 - API 594 - ASME - BS design Std
- From size 2" to 114", Class ASME 150# to 4500#, Class 2000 Psi to Class 20000 Psi, up to 120 tons valve weight
- In carbon, low-temperature carbon steel (LTCS), low alloy carbon steel, stainless, duplex, superduplex, nickel base, inconel, hastelloys, titanium grades, and bronze alloys
- Fully clad or lined executions

Applications

Cryogenic service (to -196° Celsius), H₂S service, Lethal service, High Pressure service, Corrosive and Abrasive service, Oxygen service, Hydrogen service and others.

Cast and forged material is selected in order to satisfy service and process requirements, both for upstream, flow lines and downstream applications.

Throughout its history, **ORION** has built and maintained its premier industry position through superior product design, large and flexible production capacity, strong distribution and commitment to customer service.

Facilities and Equipment

- Large machining units for valves weighing up to 100 tons
- State of the art laboratory for valve testing simulating all service conditions in terms of temperature and pressure
- Fugitive Emission detection
- Cryogenic Testing
- Ultrasonic Cleaning
- Robotized Cladding Shop

Certifications

API 594 - API 6A - API 6D - API 6DSS - API 600 - API 609 - ISO 9001:2015
ISO 3834-2:2006 - ISO 14001:2015 - ISO 45001:2018 - PED - SIL - TRCU 10
TRCU 32 - TRCU 12 - ATEX 2014/34/UE

Special Engineered Executions

In addition to the standard service valve production, **ORION Steel Valves** supplies a range of valves dedicated to specific process requirements.

CRYOGENIC SERVICE VALVES

These valves are suitable for low temperature or cryogenic operating conditions, with a particular selection of materials suitable for low temperatures and the extended bonnet design in order to keep the stem packing protected from cryogenic fluid. (Design standards i.e. BS6364, MESG SPE 77-200, ...)

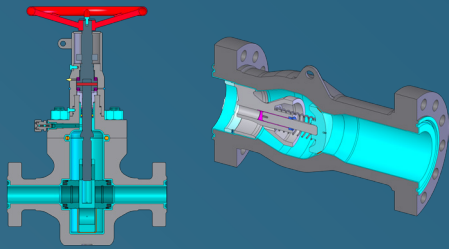
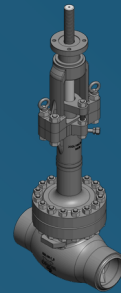

INTERNAL CLADDING

Valves internally cladded are the alternative offered by **ORION** in harsh service conditions. We can use valves made of carbon steel with the entire internal surfaces lined with INCONEL®, HASTELLOY® alloys or other weldable steels or CRAs. The latest technologies for weld depositing are available in **ORION** to provide a controlled layer of metal, able to improve the corrosive and erosive resistance of the valve parts.

INTERNAL LINING

The entire production range of **ORION** valves is also available with an internal lining of polymeric products, like FBE lining. The exposed surfaces (floating seat pockets and gasket seating areas) are overlaid with a stainless steel or CRA which ensures a long lasting performance of the valve and a total protection of the wetted surfaces.

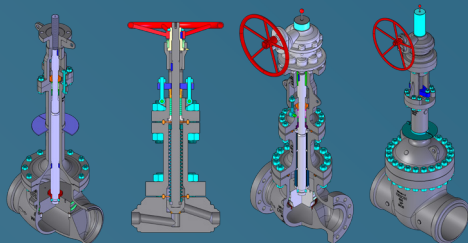
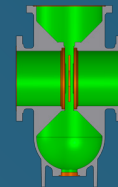

BELLOW SEALED VALVES

ORION offers bellow sealed valves for lethal, toxic and highly flammable services in order to reach the total absence of emissions. The bellow creates a physical barrier that isolates the fluid from the external environment. Traditional stem packing arrangement is still kept in place as a second contingency barrier and to maintain fire safe design.

JACKETED VALVES

To keep the valve operating temperature under control, a jacketed execution is available. The valve is enclosed into a cast steel or fabricated jacket, creating an interstice all around the body. A heating fluid is forced to flow through this interstice and keeps the valve at a controlled temperature, in order to keep the process fluid's viscosity low and avoid accumulation of material in the body. Usually sulphur and polymers application require this particular feature. The use of a jacket requires an increased flange size dimension, usually to the next size.

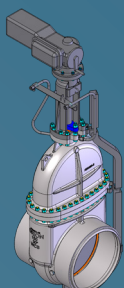
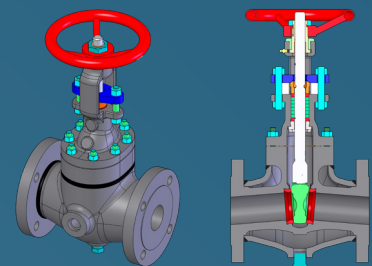

BURIED SERVICE VALVES

Extended drain, vent and injection piping is supplied for valves built for buried underground service.

POST - INDICATOR VALVES (PIV)

Similarly to buried valves, this kind of equipment has a stem extension with an open-close indicator directly positioned above ground, close to the handwheel, in order to easily check the opening status of the valve.

Products

ORION - Steel valves

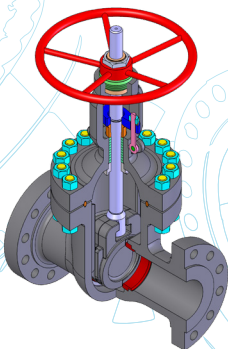

GATE VALVES

Pressure rating	Nominal size
from 150 to 600	from 2" to 114"
class 900	from 2" to 60"
class 1500	from 2" to 48"
class 2500	from 2" to 30"

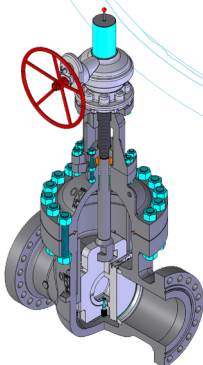

DOUBLE DISC AND PARALLEL SLIDE GATE VALVES

Pressure rating	Nominal size
from 150 to 600	from 2" to 60"
class 900	from 2" to 48"
class 1500	from 2" to 36"
class 2500	from 2" to 30"

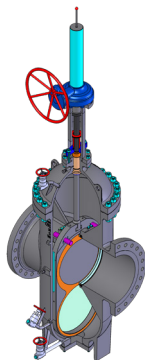

THROUGH CONDUIT GATE VALVES

Pressure rating	Nominal size
from 150 to 600	from 2" to 60"
class 900	from 2" to 48"
class 1500	from 2" to 30"
class 2500	from 2" to 24"

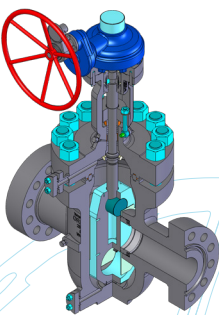

THROUGH CONDUIT ISNRS GATE VALVES

Pressure rating	Nominal size
from 150 to 600	from 2" to 60"
class 900	from 2" to 48"
class 1500	from 2" to 30"
class 2500	from 2" to 24"

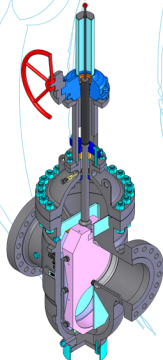

EXPANDING GATE VALVES

Pressure rating	Nominal size
from 150 to 600	from 2" to 60"
class 900	from 2" to 48"
class 1500	from 2" to 36"
class 2500	from 2" to 24"

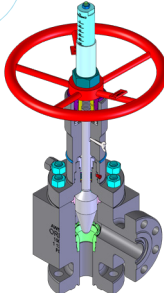
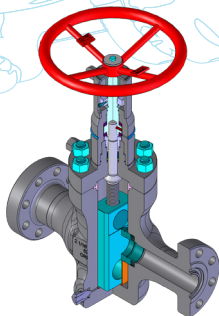

WELLHEAD VALVES

Pressure rating	Nominal size
from 2000 to 3000	from 2 1/16" to 21 1/4"
class 5000	from 2 1/16" to 21 1/4"
class 10.000	from 1-13/16" to 13 5/8"
class 15.000	from 1-13/16"-9"

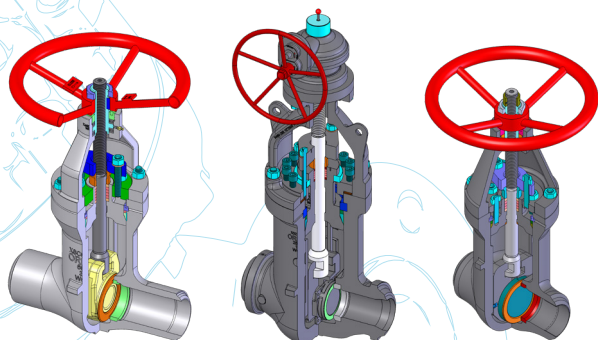

PRESSURE SEAL BONNET GATE VALVES

Pressure rating	Nominal size
class 600	from 2" to 66"
class 900	from 2" to 60"
class 1500	from 2" to 48"
class 2500	from 2" to 30"

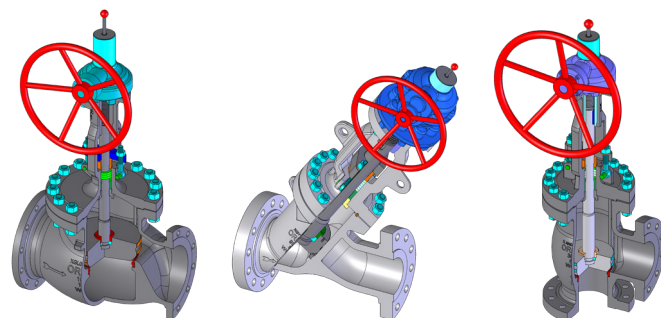

GLOBE & ANGLE VALVES

Pressure rating	Nominal size
from 150 to 600	from 2" to 42"
class 900	from 2" to 36"
class 1500	from 2" to 30"
class 2500	from 2" to 24"

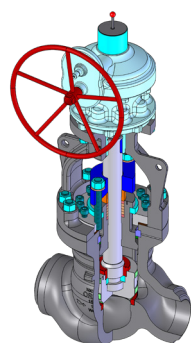

P.S. SEAL BONNET GLOBE VALVES

Pressure rating	Nominal size
class 600	from 2" to 42"
class 900	from 2" to 36"
class 1500	from 2" to 30"
class 2500	from 2" to 20"

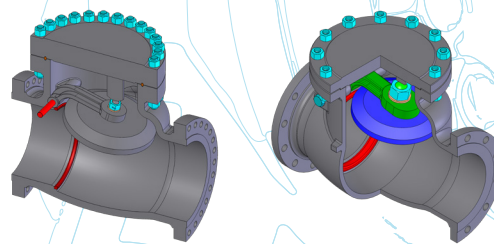

SWING CHECK VALVES

Pressure rating	Nominal size
from 150 to 600	from 2" to 66"
class 900	from 2" to 60"
class 1500	from 2" to 48"
class 2500	from 2" to 30"

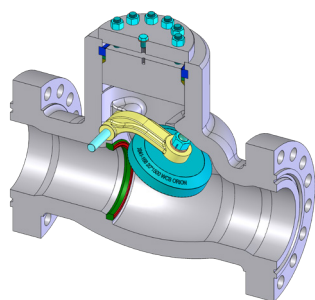

PRESSURE SEAL COVER CHECK VALVES

Pressure rating	Nominal size
class 600	from 2" to 66"
class 900	from 2" to 60"
class 1500	from 2" to 48"
class 2500	from 2" to 30"

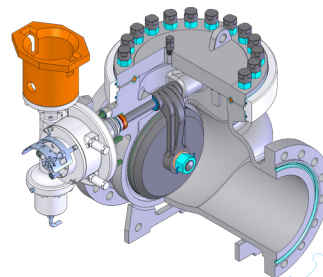

SWING CHECK SUB SEA VALVES

Pressure rating	Nominal size
from 150 to 600	from 2" to 60"
class 900	from 2" to 52"
class 1500	from 2" to 42"
class 2500	from 2" to 24"

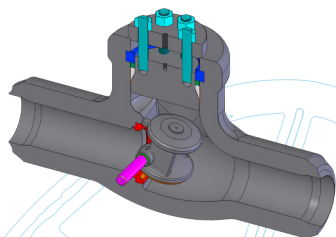

PRESSURE SEAL TILTING DISC VALVES

Pressure rating	Nominal size
from 150 to 600	from 2" to 66"
class 900	from 2" to 60"
class 1500	from 2" to 48"
class 2500	from 2" to 30"

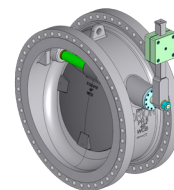
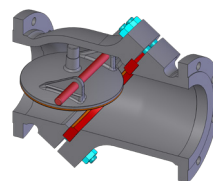
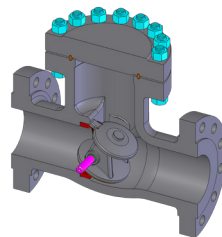

TILTING DISC CHECK VALVES

Pressure rating	Nominal size
from 150 to 600	from 2" to 66"
class 900	from 2" to 60"
class 1500	from 2" to 48"
class 2500	from 2" to 30"

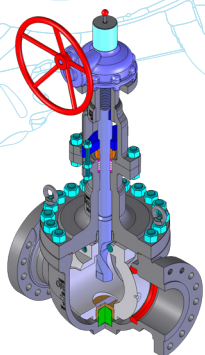

RISING STEM BALL VALVES

Pressure rating	Nominal size
from 150 to 600	from 2" to 24"
class 900	from 2" to 20"
class 1500	from 2" to 16"
class 2500	from 2" to 12"

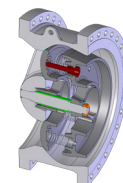
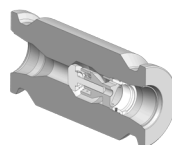
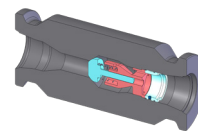
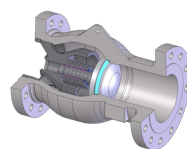

AXIAL CHECK VALVES

Pressure rating	Nominal size
from 150 to 600	from 2" to 80"
class 900	from 2" to 52"
class 1500	from 2" to 42"
class 2500	from 2" to 30"

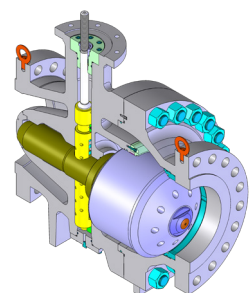

AXIAL VALVES

Pressure rating	Nominal size
class 150-600	from 4" to 60"
class 900	from 4" to 48"
class 1500	from 4" to 30"
class 2500	from 6" to 20"

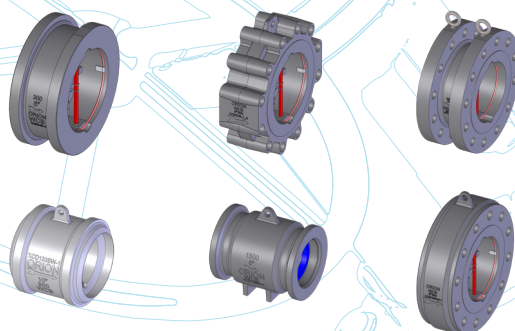

DUAL PLATE CHECK VALVES

Pressure rating	Nominal size
from 150 to 600	from 2" to 48"
class 900	from 2" to 24"
class 1500	from 2" to 30"
class 2500	from 2" to 24"

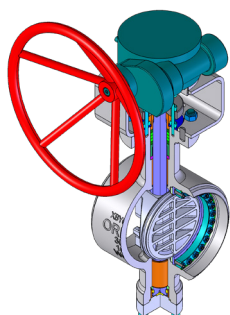

BUTTERFLY TOV

Pressure rating	Nominal size
class 150	from 3" to 36"
class 300	from 3" to 36"
class 600	from 3" to 24"

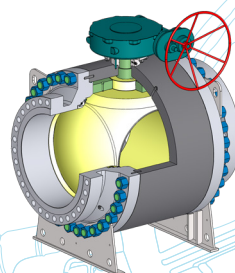

BALL VALVES

Pressure rating	Nominal size
from 150 to 600	from 2" to 64"
class 900	from 2" to 48"
class 1500	from 2" to 48"
class 2500	from 2" to 24"

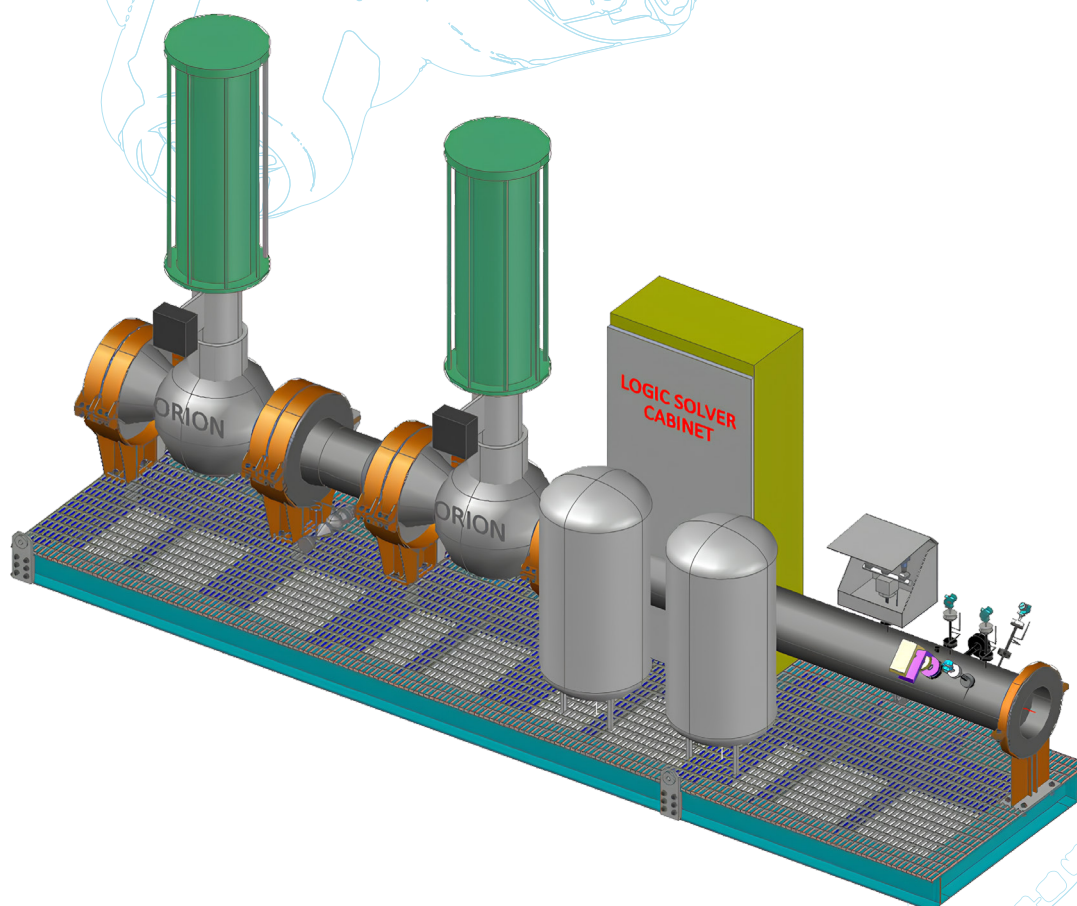

HIPPS

Type	Valves	Controls
Loose	Axial flow	Electronic
SKID mounted	Ball	Mechanical
	Gate	
	Butterfly	



ORION S.p.A. Headquarters and plant Via Caboto 8 - 34147 Trieste, Italy

ORION Valves DMCC Tiffany Tower Unit 907, JLT Cluster W, Dubai, UAE

SPSV Street 85 Intersection Street 128, Second Industrial City, Dammam – Kingdom Of Saudi Arabia
PO BOX 3942 Al Khobar 31952